

<b>PNC</b>	<b>Type/Prefix/nd</b>	<b>Model</b>	<b>Brand</b>
953900691	02	MAC PAC 300	McCulloch

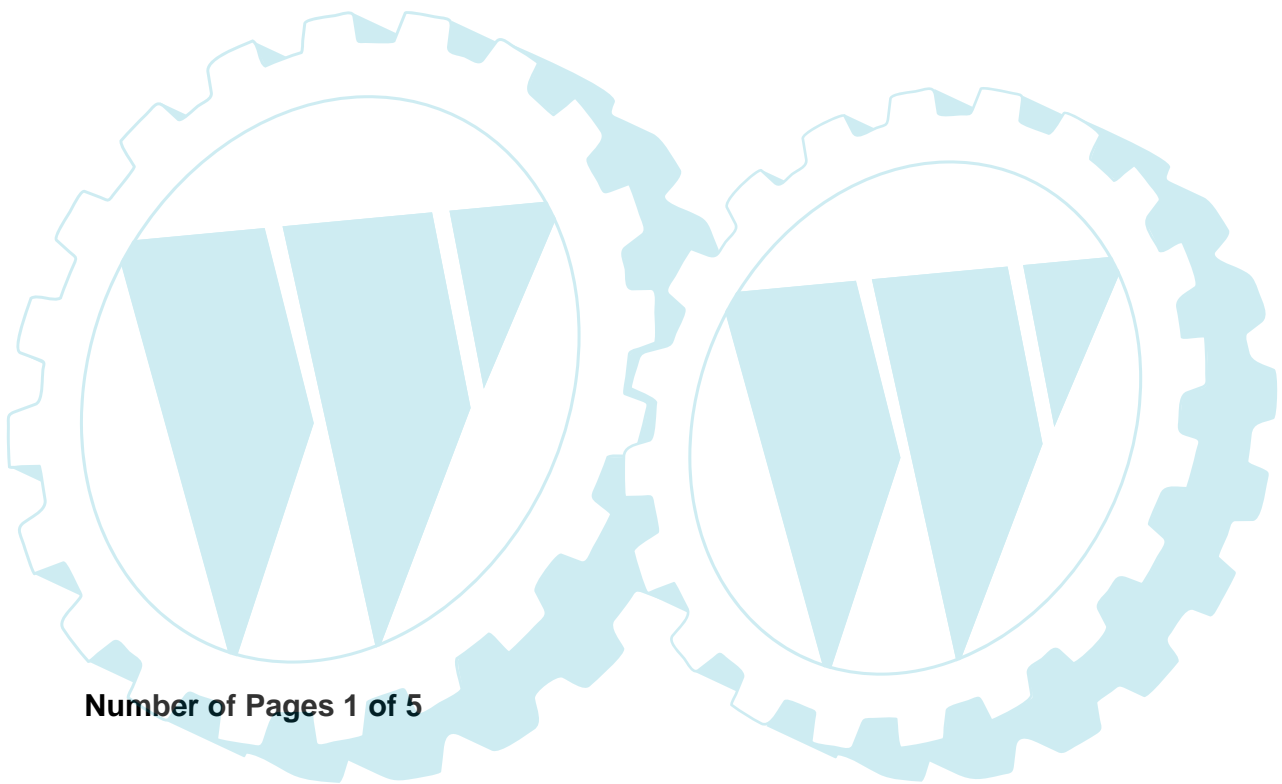

Number of Pages 1 of 5

<b>Factory:</b> IIQ - Valmadrera	<b>Product Group:</b> OP 93
<b>Publication Number:</b> MIPL2006_V030000005	<b>Petrol Portable</b>
<b>Publication Date:</b> 19/01/06	<b>Sub Group</b> 9433

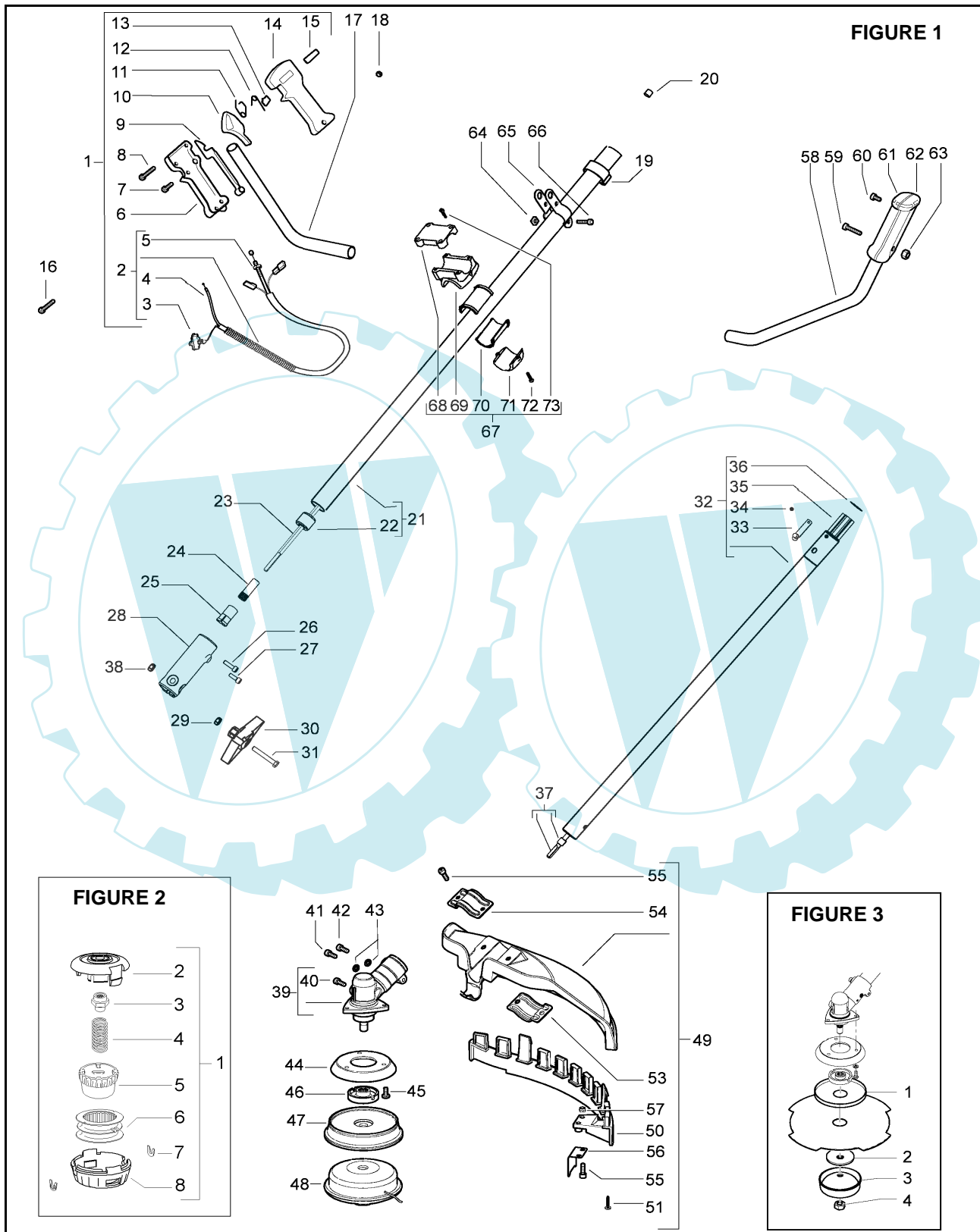

Item P/N McC P/N ELX Qty DESCRIPTION

Item P/N McC P/N ELX Qty DESCRIPTION

**FIGURE 1**

1	227089	538227089	1	trigger box assy
C 2	• 227082	538227082	1	cable assy
C 3	•• 236394	538236394	1	switch
C 4	•• 227054	538227054	1	throttle cable
5	• 235912	538235912	1	nut M6
6	• 241293	538241293	1	half handle (right)
7	• 240618	538240618	2	screw 3x16
8	• 240833	538240833	3	screw 3x20
9	• 229820	538229820	1	safety lever
10	• 241295	538241295	1	throttle trigger
11	• 240091	538240091	1	throttle trigger spring
12	• 229973	538229973	1	throttle advance spring
13	• 229823	538229823	1	throttle advance
14	• 241294	538241294	1	half handle (left)
15	• 229824	538229824	1	throttle advance slide
16	235804	538235804	1	screw M5x30
17	229831	538229831	1	right handle bar
18	235216	538235216	1	nut M5
19	229850	538229850	2	cable retain
20	243290	538243290	1	shaft retainer ring
21	243156	538243156	1	upper shaft assy
22	• 228192	538228192	3	bushing assy
23	243178	538243178	1	shaft
24	11248	538011248	1	bushing
25	11249	538011249	1	shaft joint
26	229077	538229077	1	screw M5x18
27	236381	538236381	1	screw M5x10
28	243180	538243180	1	joint
29	235912	538235912	1	nut M6
30	502203802	502203802	1	knob
31	242146	538242146	1	screw M6x40
32	249721	538249721	1	lower shaft assy
33	• 243395	538243395	1	button
34	• 243396	538243396	1	rivet
35	• 243206	538243206	1	shaft guide
36	• 242831	538242831	2	shaft guide retainer ring
37	243211	538243211	1	shaft + retainer
38	228926	538228926	1	self locking nut M6
39	242728	538242728	1	gearbox
40	• 240151	538240151	1	screw M8x10
41	235802	538235802	1	screw 5x14
42	235803	538235803	1	screw 5x25
43	236529	538236529	2	split washer
44	242729	538242729	1	flange adapter
45	240688	538240688	3	screw M5 and washer
A 46	242815	538242815	1	flange
B 47	242823	538242823	1	spacer
A 48			1	string head

**FIGURE 2**

B 49	249155	538249155	1	guard ass'y
B 50	• 242644	538242644	1	guard extension
51	• 240862	538240862	1	screw M5x14
53	• 242752	538242752	1	lower clamp
54	• 242629	538242629	1	upper clamp
55	• 227563	538227563	4	screw M5x16
56	• 241973	538241973	1	line cutter
57	• 229208	538229208	2	nut
58	229832	538229832	1	left handle bar
59	235212	538235212	1	screw M5x35
60	240833	538240833	1	screw M3x20
61	229985	538229984	1	left handle (right half)
62	229984	538229985	1	left handle (left half)
63	235216	538235216	1	nut M5
64	236642	538236642	2	nut M6
65	228152	538228152	2	harness clamp (1 half)
66	235911	538235911	2	screw M6x12
67	243428	538243428	1	handle clamp assy
68	• 242200	538242200	1	upper clamp
69	• 243082	538243082	1	handle clamp
70	• 241684	538241684	2	d .25 adapter
71	• 242900	538242900	1	lower clamp
72	• 229077	538229077	2	screw M5x18
73	• 235803	538235803	4	screw M5x25

**FIGURE 2**

A 1	531025001	531025001	1	P 25 trimmer head
2	• 537419302	537419302	1	body
3	• 537338901	537338901	1	adapter T25
C 4	• 537338801	537338801	1	spring T25
C 5	• 537419601	537419601	1	knob
C 6	• 537419501	537419501	1	spool without line
C 7	• 537419701	537419701	2	bushing
8	• 537419401	537419401	1	cover

**FIGURE 3**

B 1	241155	538241155	1	flange
A 2	241006	538241006	1	plate blade
A 3	236596	538236596	1	cup
A 4	240481	538240481	1	nut

A=ALTA ROTAZIONE  
B=MEDIA ROTAZIONE  
C=ALTA ROTAZIONE  
NUOVI CODICI

A=HIGH MOVING  
B=MEDIUM MOVING  
C=SLOW MOVING  
NEW P. NUMBERS

A=HAUTE DEMANDE  
B=MOYENNE DEMANDE  
C=BASSE DEMANDE  
NOUVELLES REFERENCES

A=GROBE NACHFRAGE  
B=MITTELMAESSIGE  
C=WENIGE NACHFRAGE  
NEU CODEX

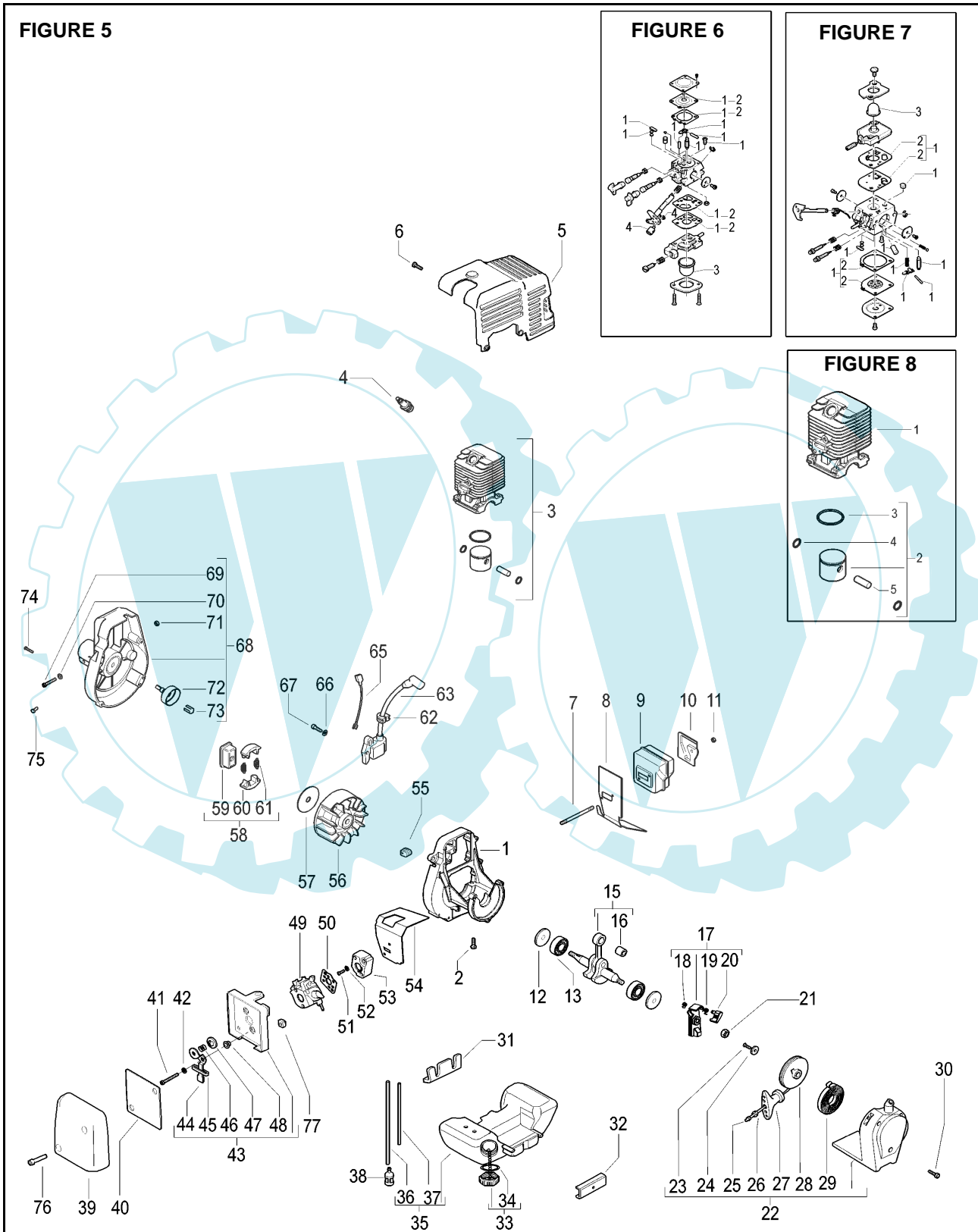

Item	P/N McC	P/N ELX	Qty	DESCRIPTION
<b>FIGURE 5</b>				
1	242802	538242802	1	crankcase
2	227565	538227565	4	screw M5x25
3	<b>FIGURE 8</b>			
A 4	92879	538092879	1	spark plug RDJ8J
5	243488	538243488	1	engine cover
6	241963	538241963	2	screw M4x22
7	242037	538242037	2	stud bolt
B 8	243273	538243273	1	exhaust gasket
C 9	242131	538242131	1	muffler
10	323760	538323760	1	muffler shield
11	235642	538235642	2	nut M5
C 12	242994	538242994	2	seal
C 13	241594	538241594	2	ball bearing
15	243486	538243486	1	crankshaft assy
C 16	• 235742	538235742	1	needle bearing
17	241784	538241784	1	starter pawl assy
18	• 111088	538111088	1	snap ring
19	• 241782	538241782	1	spring
20	• 241781	538241781	1	pawl
21	235248	538235248	1	nut
C 22	242041	538242041	1	starter assy
23	• 240862	538240862	1	screw M4x18
24	• 241703	538241703	1	washer
A 25	• 241746	538241746	1	rope
26	• 235612	538235612	1	washer
27	• 241778	538241778	1	handle
B 28	• 241620	538241620	1	pulley
B 29	• 241619	538241619	1	spring
30	241963	538241963	3	screw M4x20
31	242038	538242038	1	tank grommet (crankcase side)
32	242039	538242039	1	tank grommet (starter side)
B 33	242484	538242484	1	fuel tank cap assy
A 34	• 236564	538236564	1	gasket
C 35	242040	538242040	1	fuel tank assy
B 36	• 229717	538229717	1	hose
B 37	• 229743	538229743	1	primer bulb hose
A 38	93720	538093720	1	fuel pickup
39	243489	538243489	1	air filter cover
B 40	227023	538227023	1	air filter
41	235808	538235808	2	screw 5x50
42	235248	538235248	1	washer
43	248485	538248485	1	air box assy
44	• 241769	538241769	1	choke lever
45	• 241622	538241622	1	choke lever grommet
46	• 235822	538235822	1	spring
47	• 241602	538241602	1	choke shutter
48	• 227022	538227022	2	bushing
C 49	<b>FIGURE 6 / FIGURE 7</b>			
A 50	241600	538241600	1	carb. Gasket
51	235806	538235806	2	screw M5x20
52	235248	538235248	2	washer

Item	P/N McC	P/N ELX	Qty	DESCRIPTION
B 53	241750	538241750	1	carb. Spacer
B 54	242860	538242860	1	intake gasket
55	241607	538241607	1	grommet
56	243311	538243311	1	flywheel
57	241604	538241604	1	dust shield
B 58	241793	538241793	1	clutch assy
59	• 241789	538241789	1	clutch hub
60	• 241743	538241743	2	clutch shoe
A 61	• 241794	538241794	2	clutch spring
62	236322	538236322	1	grommet
C 63	243429	538243429	1	ignition coil
65	241606	538241606	1	ground wire
66	235248	538235248	2	washer
67	235806	538235806	2	screw M5x20
C 68	241725	538241725	1	joint assy
69	• 235803	538235803	1	screw M5x25
70	• 235248	538235248	1	washer
71	• 229524	538229524	1	nut M5
72	• 241785	538241785	1	clutch drum
73	• 228260	538228260	1	pin
74	227568	538227568	4	screw M4x20
75	236981	538236981	1	screw 3,5x9,5
76	235803	538235803	2	screw M5x25
77	229524	538229524	2	nut M5

<b>FIGURE 6</b>		<b>WALBRO WT 686</b>	
C -	242932	538242932	carb.
B 1	• 324013	538324013	K20 rep. Kit
A 2	•• 324009	538324009	D20 gasket kit
C 3	• 225834	538225834	primer bulb
4	• 224466	538224466	swivel kit

<b>FIGURE 7</b>		<b>ZAMA C1Q M38</b>	
C -	-	-	carb.
B 1	• 300465	538300465	RB-28 rep.kit
A 2	•• 300473	538300473	diaph/gasket kit
C 3	• 246946	538246946	primer bulb

<b>FIGURE 8</b>		<b>cylinder, piston 29cc</b>	
C 1	243076	538243076	1 cylinder
C 2	249179	538249179	1 piston kit
B 3	• 242602	538242602	1 piston ring
4	• 235008	538235008	2 snap ring
5	• 241735	538241735	1 piston pin

A=ALTA ROTAZIONE  
B=MEDIA ROTAZIONE  
C=ALTA ROTAZIONE  
NUOVI CODICI

A=HIGH MOVING  
B=MEDIUM MOVING  
C=SLOW MOVING  
NEW P. NUMBERS

A=HAUTE DEMANDE  
B=MOYENNE DEMANDE  
C=BASSE DEMANDE  
NOUVELLES REFERENCES

A=GROBE NACHFRAGE  
B=MITTELMAESSIGE  
C=WENIGE NACHFRAGE  
NEU CODEX